

## DensGlass® Sheathing helps Parex USA, Inc.'s Parex R/DGG Exterior Cladding System pass strict Miami-Dade County High Velocity Hurricane tests

The ability to withstand the destructive winds and the impact of various objects during a hurricane in a coastal area is key to the survival of any exterior cladding system. Parex USA, Inc.'s Parex® R/DGG exterior cladding system, utilizing DensGlass® Sheathing from Georgia-Pacific Gypsum, passed the strict Miami-Dade County and Florida Building Code requirements for High Velocity Hurricane Zones (HVHZ)<sup>1</sup>. The system was tested independently to determine the performance against specific criteria for impact resistance, air and water infiltration resistance and wind load resistance.

### Miami-Dade Notice of Acceptance (NOA) for exterior cladding system

Parex USA, Inc. received the NOA from Miami-Dade's Building Code Compliance Office (BCCO) confirming that their independent testing was accepted for the Parex R/DGG exterior wall system, which utilizes 1/2" DensGlass Sheathing as part of the system. The wall system received a rating for Large and Small Missile Impact and met structural load and cyclic pressure testing. DensGlass Sheathing has fiberglass mats on front and back, rather than paper facings, and its versatility allows it to be used as a substrate behind Exterior Insulation and Finishing Systems (EIFS), stucco, brick and other cladding material.

The tests conducted included Florida Building Code Testing Application Standards:

- TAS 201-Large and Small Missile Test Standards
- TAS 202-Uniform Structural Load Standards
- TAS 203-Uniform Cyclic Pressure Test Standards

Coastal communities from Delaware to Texas now utilize the high standards of Miami-Dade County and the Florida Building Code requirements for High Velocity Hurricane Zones, even though their own communities have not written the standards into their local codes.

Independently, DensGlass Sheathing was recently tested in accordance with ASTM E 330 by Hurricane Test Laboratory and surpassed existing wind load values. The test evaluates the structural performance of exterior building materials under uniform static air pressure difference, using a test chamber.<sup>2</sup>

The fiberglass mats that make DensGlass Sheathing moisture and mold-resistant penetrate into the panel during the manufacturing process to create an integrated unit that offers superb strength and outstanding resistance to delamination, deterioration, warping and job site damage. Additionally, the mats provide an excellent bonding surface for EIFS. The flexural strength of DensGlass® Sheathing is

approximately the same in both directions. This means the product can be installed vertically or horizontally, without sacrificing wall strength between studs and also protects and helps stabilize structural framing.

DensGlass Sheathing is extremely resistant to rippling, buckling and sagging, even under humid conditions, which makes it particularly suitable for soffits. DensGlass Sheathing exceeded ASTM C 1396 standards for humidified deflection by a factor of five times over the standard for paper-faced gypsum sheathing.

### Negative Uniform Lateral Load Values for 5/8" (15.9 mm) DensGlass Sheathing

5/8" (15.9 mm) DensGlass Sheathing, Horizontal Application				
Studs, In. O.C.	Screws, In. O.C.	Ultimate, PSF	Safety Factor 3	
			PSF	MPH
16	8	127	42.3	129
16	6	142	47.3	136
16	4	192	64.0	158
12	8	157	52.3	143
12	6	204	68.0	163
12	4	270	90.0	188
8	8	208	69.3	165
8	6	354	118.0	215
8	4	410	136.7	231

### Parex® R/DGG Exterior Wall System over DensGlass® Sheathing<sup>3</sup>

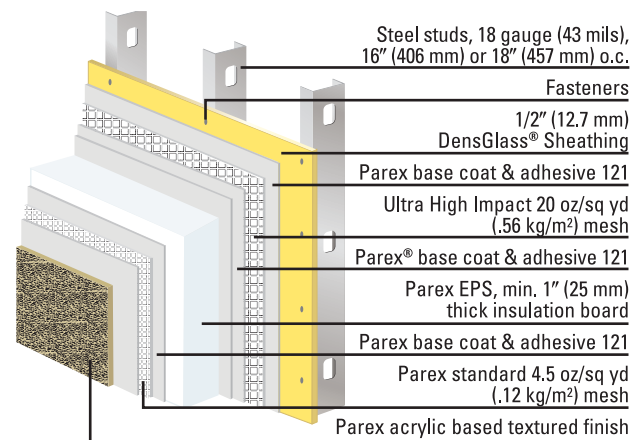

<sup>1</sup> Florida Product Approval 8605-R2; Miami-Dade County NOA No. 10-0331.01 Consult listings for current status and further information.

<sup>2</sup> For a copy of the report #G488-1001-07, contact Georgia-Pacific Gypsum Technical Hotline at 800-225-6119.

<sup>3</sup> Illustration not intended for specification purposes. Consult Miami-Dade County NOA No. 10-0331.01 at [www.miamidade.gov/buildingcode](http://www.miamidade.gov/buildingcode) for specific detail.

**Additional Benefits of DensGlass® Sheathing:**

- Noncombustible as described and tested in accordance with ASTM E 136
- 5/8" (15.9 mm) DensGlass Sheathing meets ASTM E 119/ CAN ULC S-101 for a variety of UL/ULC listings and other designs in the GA-600 Fire Resistance Design Manual
- A superior substrate for a wide variety of air, vapor and water resistive barrier systems
- Is lightweight and easy to handle; can be cut and fastened with standard drywall tools and fasteners
- 12-month weather exposure limited warranty<sup>4</sup>
- 5-year limited warranty against manufacturing defects<sup>4</sup>
- 12-year substrate limited warranty in architecturally specified EIFS<sup>4</sup>

<sup>4</sup> For warranty details, please visit [www.gpgypsum.com](http://www.gpgypsum.com).



**The Effect Of Wind On A Building**

During high wind events, building envelopes suffer from the effects of shifting internal and external pressures. Positive pressure will peel exterior claddings and sheathings off the top of the structure and negative pressure, swirling behind the building will do the same. Building materials that connect the roof decking to the building envelope and that have superior wind load values when properly installed will minimize this type of damage during strong storms and hurricanes.

U.S.A. – Georgia-Pacific Gypsum LLC  
 Canada – Georgia-Pacific Canada LP

**Sales Information & Order Placement**

U.S.A. Midwest: **1-800-876-4746**  
 West: **1-800-824-7503**  
 South: **1-800-327-2344**  
 Northeast: **1-800-947-4497**

CANADA Canada Toll Free: **1-800-387-6823**  
 Quebec Toll Free: **1-800-361-0486**

**Technical Information**

Georgia-Pacific Gypsum Technical Hotline  
 U.S.A. and Canada: **1-800-225-6119**  
[www.gpgypsum.com](http://www.gpgypsum.com)



**TRADEMARKS** BUILDING REPUTATIONS TOGETHER, DENSGLOSS and the GEORGIA-PACIFIC logo are trademarks owned by or licensed to Georgia-Pacific Gypsum LLC. PAREX is a trademark of Parex USA, Inc. USGBC and related logo is a trademark owned by the U.S. Green Building Council and is used by permission.

**WARRANTIES, REMEDIES AND TERMS OF SALE**

For current warranty information for this product, please go to [www.gpgypsum.com](http://www.gpgypsum.com) and select the product for

warranty information. All sales of this product by Georgia-Pacific are subject to our Terms of Sale available at [www.gpgypsum.com](http://www.gpgypsum.com). Georgia-Pacific makes no representations or warranties regarding Parex products or any component other than DensGlass Sheathing. For additional information concerning Parex, contact Parex at 866-516-0061 or go to [www.parex.com](http://www.parex.com).

**UPDATES AND CURRENT INFORMATION** The information in this document may change without notice. Visit our website at [www.gpgypsum.com](http://www.gpgypsum.com) for updates and current information.

**CAUTION** For fire, safety and use information concerning DenGlass Sheathing go to [www.gp.com/safetyinfo](http://www.gp.com/safetyinfo). For fire, safety and use information concerning Parex, contact Parex at 866-516-0061 or go to [www.parex.com](http://www.parex.com).

**HANDLING AND USE-CAUTION** This product contains fiberglass facings which may cause skin irritation. Dust and fibers produced during the handling and installation of the product may cause skin, eye and respiratory tract irritation. Avoid breathing dust and minimize contact with skin and

eyes. Wear long sleeve shirts, long pants and eye protection. Always maintain adequate ventilation. Use a dust mask or NIOSH/MSHA approved respirator as appropriate in dusty or poorly ventilated areas. For handling and use information concerning Parex products, please contact Parex at 866-516-0061 or go to [www.parex.com](http://www.parex.com).

**FIRE SAFETY CAUTION** Passing a fire test in a controlled laboratory setting and/or certifying or labeling a product as having a one-hour, two-hour, or any other fire resistance or protection rating and, therefore, as acceptable for use in certain fire rated assemblies/systems, does not mean that either a particular assembly/system incorporating the product, or any given piece of the product itself, will necessarily provide one-hour fire resistance, two-hour fire resistance, or any other specified fire resistance or protection in an actual fire. In the event of an actual fire, you should immediately take any and all actions necessary for your safety and the safety of others without regard for any fire rating of any product or assembly/system.

