

*ATTIC DETAIL-ADJACENT TO TRUSSES

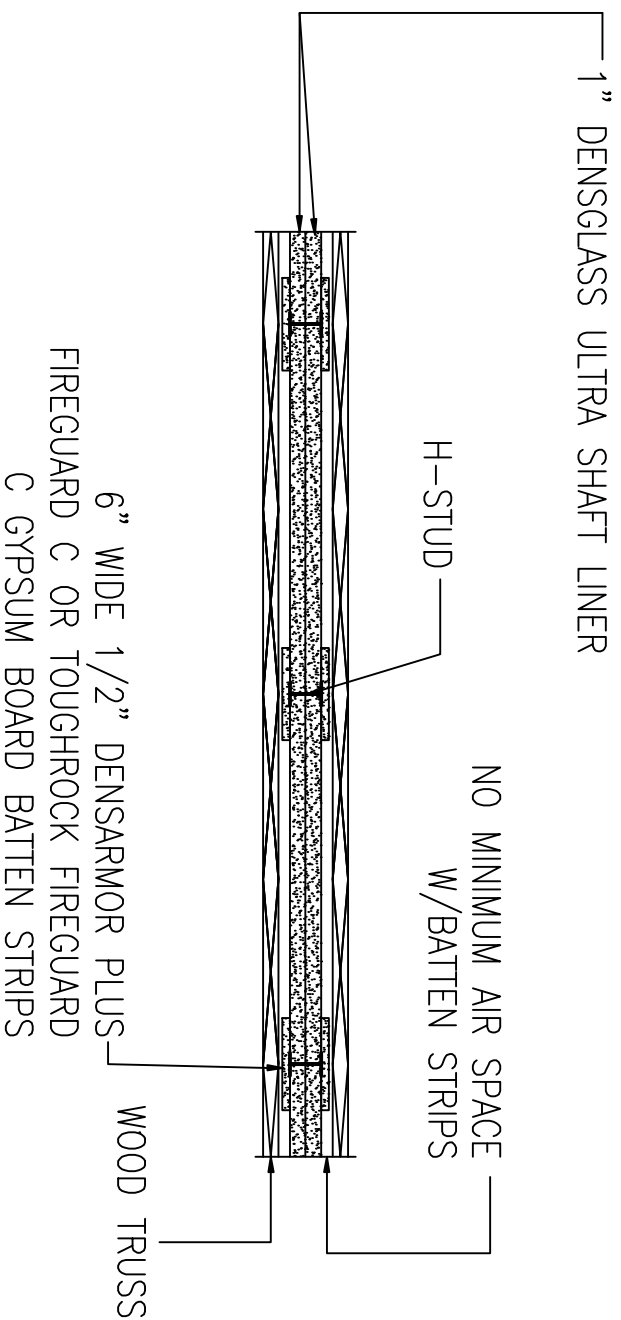

*ONLY APPLIES IF SOLID WALL IS ACCESSIBLE. IF NOT ACCESSIBLE, THE 1/2" TYPE C STRIPS ARE NOT REQUIRED.

GEORGIA-PACIFIC GYPSUM, LLC IS PROVIDING THIS DETAIL AS A SERVICE TO OUR CUSTOMERS. PLEASE OBTAIN APPROVAL FROM THE PROJECT'S ARCHITECT, ENGINEER OR OTHER DESIGN AUTHORITY AND REVIEW WITH LOCAL BUILDING CODE OFFICIALS BEFORE YOU IMPLEMENT THIS DETAIL.